

# CERTIFICATE OF LOCATION OF GOVERNMENT CORNER

EAST QUARTER Corner of Section 8, Township 106N, Range 40W

5th Principal Meridian, State of Minnesota, County of Murray.

At the corner location shown on the sketch:

☐ On \_\_\_\_\_ found a \_\_\_\_\_  
DATE

☐ left monument as found ☐ lowered monument ☐ removed monument (explain)

☒ On 10/16/2021 placed a 1/2"x18" REBAR CAPPED "RLS 57085".  
DATE

## SKETCH OF REFERENCE TIES

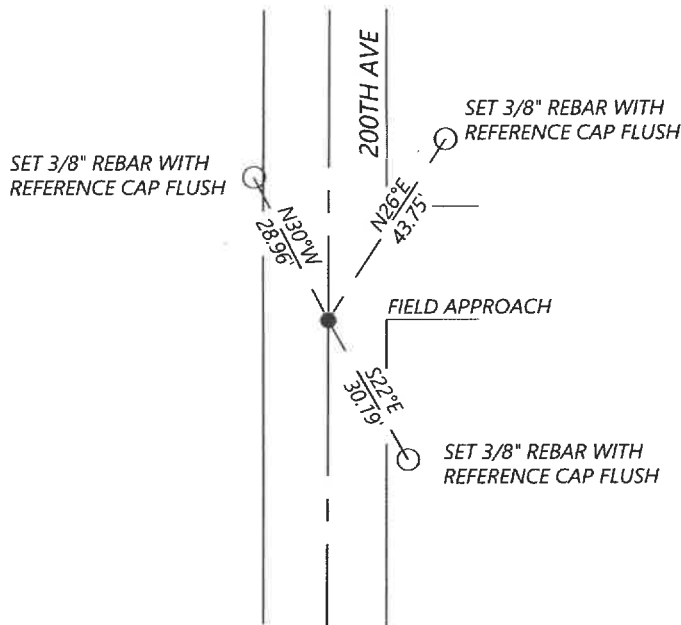

N.T.S.

Statement of evidence for this corner location is on back of this page.

I hereby certify that this document was researched and prepared by me or under my direct supervision and that I am a licensed Land Surveyor under the laws of the State of Minnesota.

Signature [Signature]

Date 4-18-2022 License No. 57085

Title:

☒ Land Surveyor ☐ Professional Engineer  
☐ County Surveyor ☐ County Engineer

OFFICE OF THE COUNTY RECORDER

County of Murray

I hereby certify that this document was filed in the Co.

Recorder's office at \_\_\_\_\_ M. on the 22<sup>nd</sup> day of April, A.D. 20 22

County Recorder Karen Brown

by \_\_\_\_\_, Deputy

DOCUMENT NO. \_\_\_\_\_

SETH WECKMAN  
Minnesota License No. 57085

**Statement of Evidence:**

East Quarter corner of Section 8, Township 106 North, Range 40 West, 5th Principal Meridian, Murray County, Minnesota.

1861 D.W. Wellman and S.S. Smoot, U.S. Deputy Surveyors, during the original public land survey a post was set, drove charred stake and made a mound with trench and pits.

1899 J.W. Woolstencroft, survey shows stone in grade.

1901 J.W. Woolstencroft, survey shows a stone in road.

2009 Zieske Land Surveying (Perry Zieske, LS 23008), surveys shows an iron monument in place.

2021 Westwood Professional Services searched the area and did not recover a monument. Lines of occupation consist of a North/South gravel road and a fence line running East. Re-established the corner position by using the 2009 Zieske survey and set a 1/2" x 18" rebar with cap marked, "RLS 57085". Established 3 local reference ties.

*Analysis of the recovered data, field evidence and survey measurements, indicates that the monument set is the correct perpetuation of this corner. For additional information concerning this corner please contact Westwood Professional Services.*